

FILTRO DEPURAZIONE ACQUA SERIE "TIRRENO"
OTTONE NICHELATO - Coperchio in PA6 trasparente
 WATER STRAINER "TIRRENO" PATTERN
 NICKEL-PLATED BRASS - Transparent PA6 cover

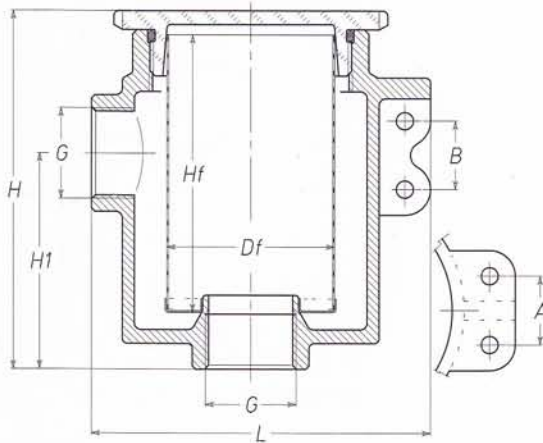

- Corpo in ottone nichelato
- Elemento filtrante in acciaio inox AISI 316L
- Coperchio in PA6 trasparente
- Guarnizioni in neoprene
- Nickel-plated brass casing
- AISI 316L stainless steel inside filter
- Transparent PA6 cover
- Neoprene o-ring



FILETTATURE / THREAD :
 G = ISO 228/1 (BS 2779)

Weight (gr)	970	940	900
H	105	105	105
H1	62	62	62
L	99	99	99
A	20	20	20
B	20	20	20
Hf	75	75	75
Df	49	49	49
G	3/8"	1/2"	3/4"

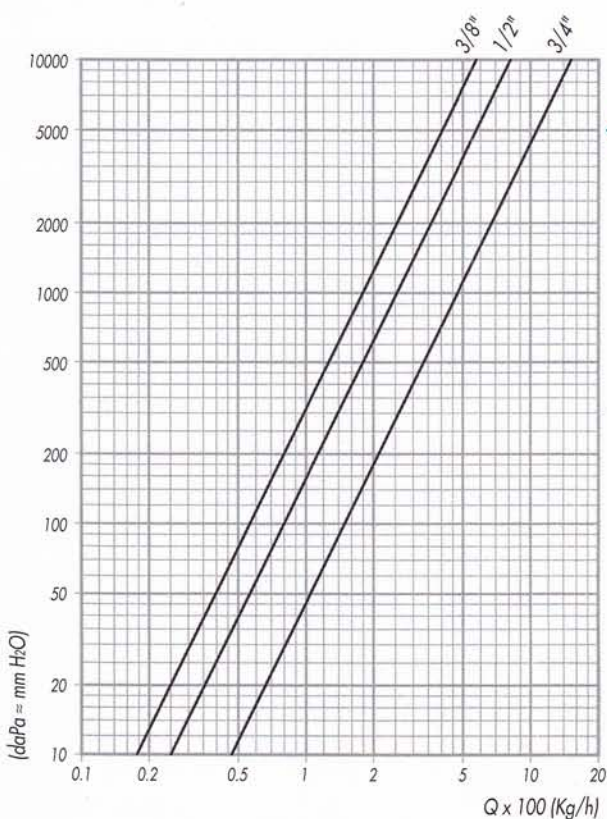

PORTATE DI ACQUA ATTRAVERSO
 IL FILTRO PULITO - lt/h
 FLOW-RATE CAPACITY THROUGH
 THE CLEAN FILTER - lt/h

G Certificato 0.1 bar 1 bar

N°	3/8"	1/2"	3/4"
2070/1	1800	5745	
2070/2	2550	8183	
2070/3	4750	15159	

OMOLOGAZIONE / CERTIFICATE
RINA DIP

